

ASSEMBLY INSTRUCTIONS

4' x 4' Raised Planter Bed

New England
Arbors
Leadership by Design

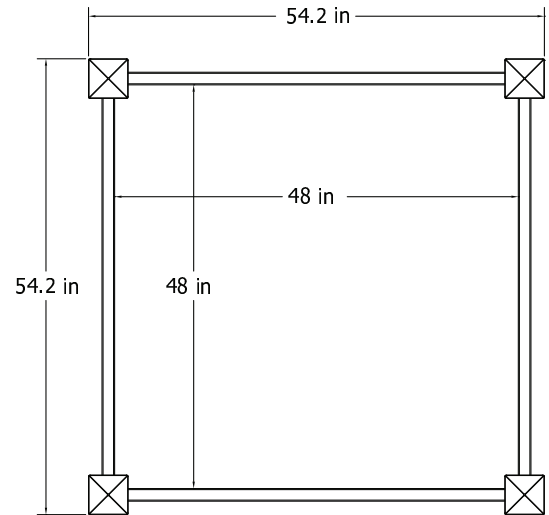
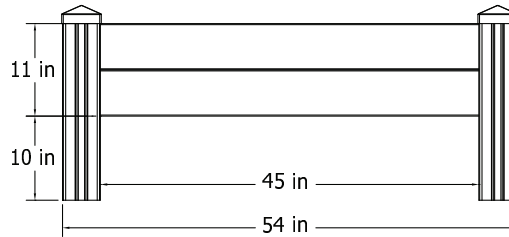
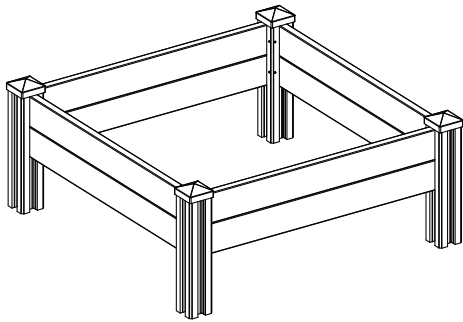

Please read through before starting assembly.

Check Box for These Contents

In the event of missing or defective parts please call our customer service dept. at **1 800 282 9346, ext #20** (Mon. to Fri. 8:00 AM to 4:00 PM EST).

1. Post Caps (4)
2. Posts (4)
3. Side Panels (8)
4. 3.5" Stainless Steel Screws (16)

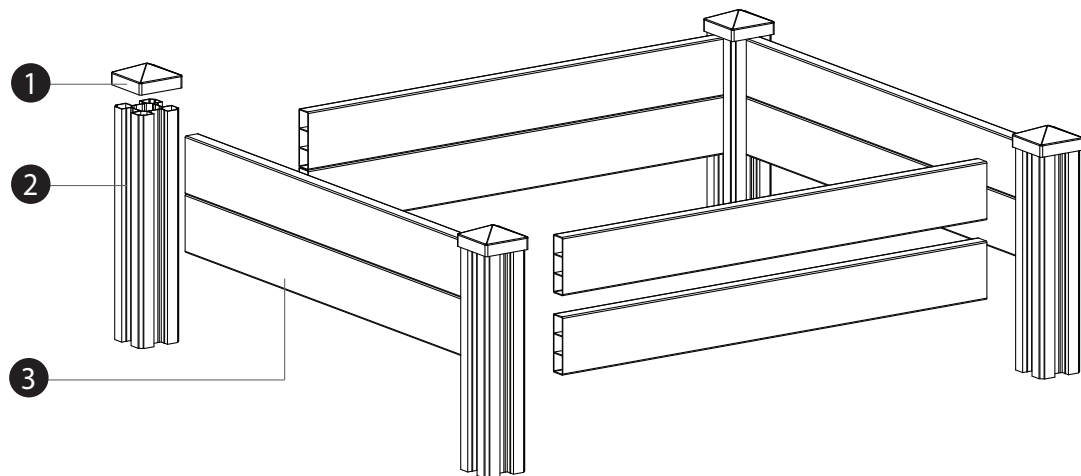

4

Not to Scale

General Information

- **Read Instructions through carefully before beginning assembly.**
- When assembling components, place on a non-abrasive surface (i.e. shipping box) to avoid scratching.
- We recommend an area approx 4'x 8' for unobstructed assembling.
- You should not need to use excessive force when assembling components.

STEP ONE

Raised Bed Installation

1

Excavate four, 8-inch holes in a square pattern (49½" x 49½") as shown aside. Holes are to be 10 inches deep.

2

Place a post into each of the four holes. The posts will be buried 10 inches into the ground.

3

Stack the side panels two high between the posts. While ensuring the posts and side panels are level, replace the excavated dirt back and around the holes.

4

Using the screws provided, fasten the side panels to the posts. (One screw for each intersection of side panel and post).

5

Pressure fit a post cap onto each of the posts.

1

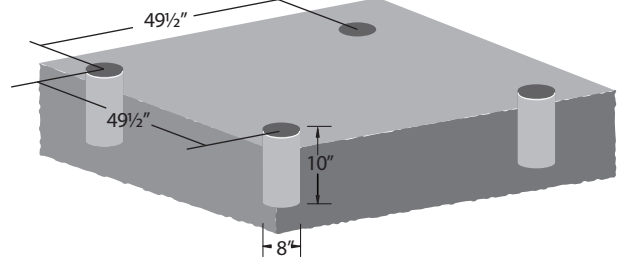

2

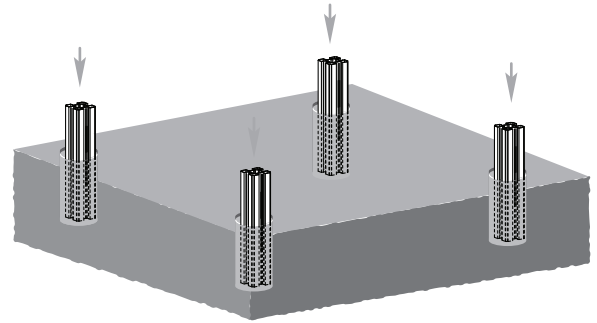

3

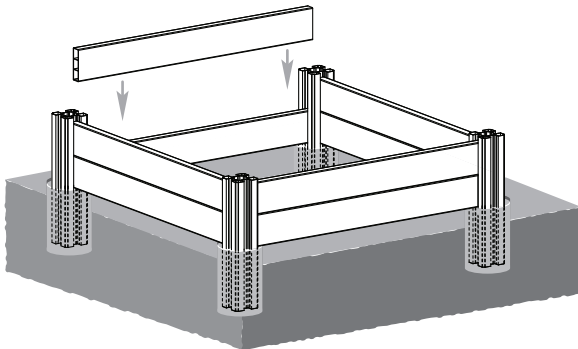

4

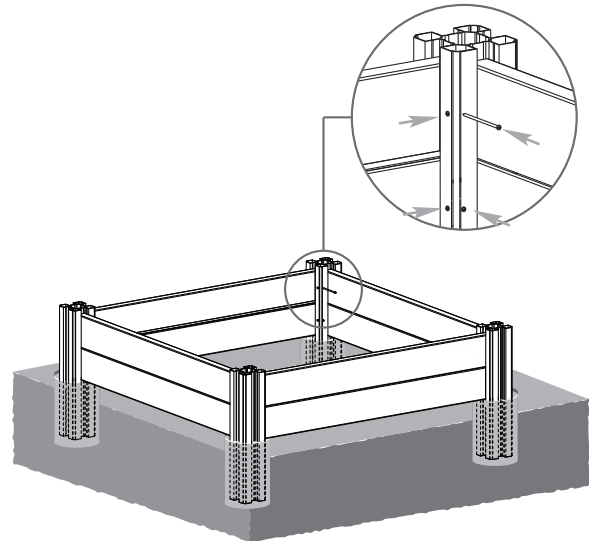

5

